

1

2

3

4

A

Technical sheet/ Datos técnicos:

Part number adaptable to / Referencia adaptable a	21116880
Operating temperature range / Rango de temperatura	-40°C a/to 80°C
Weight / Peso	63 gr

B

PIN 1	Switch/Interruptor
PIN 3	Switch/Interruptor
PIN 4	GND/Masa
PIN 5	Signal/Señal
PIN 6	+5V

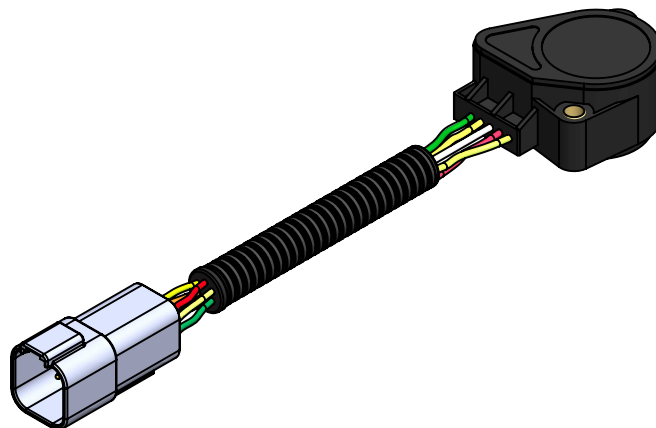

C

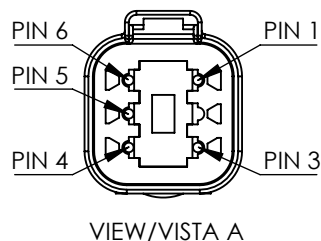

D

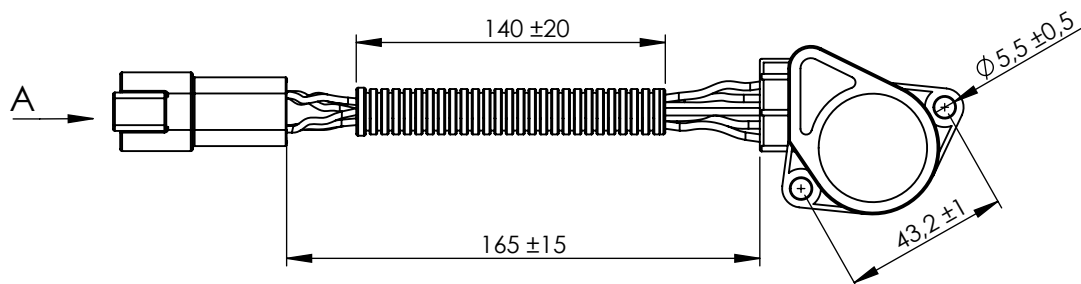

E

F

Modification	4				Drawn		
	3				31/08/20 S.F.		
	2				Checked		
	1	S.F.	17/11/22	Change sheet format	31/08/20 E.L.		
Comments	nº	Modified	Date	Reason	General Tolerance	Assembly	
					ISO 2768 c-K	Part name	Accelerator position sensor/ Sensor de posición acelerador
					Material	ID. Reference	2260209
					Scale: 1/2		Sheet 1/1
					Review: 1		