

SECTION A-A

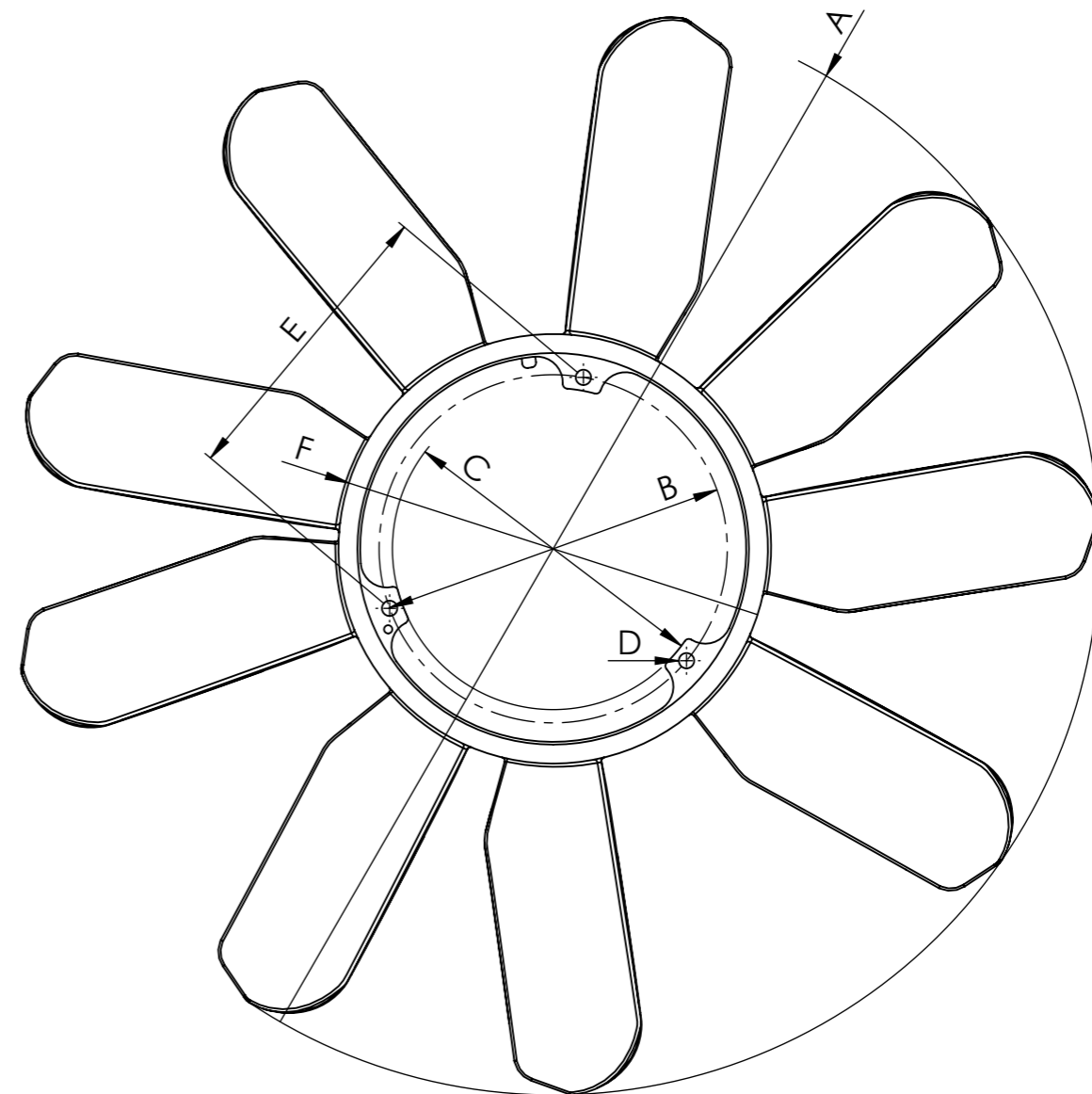
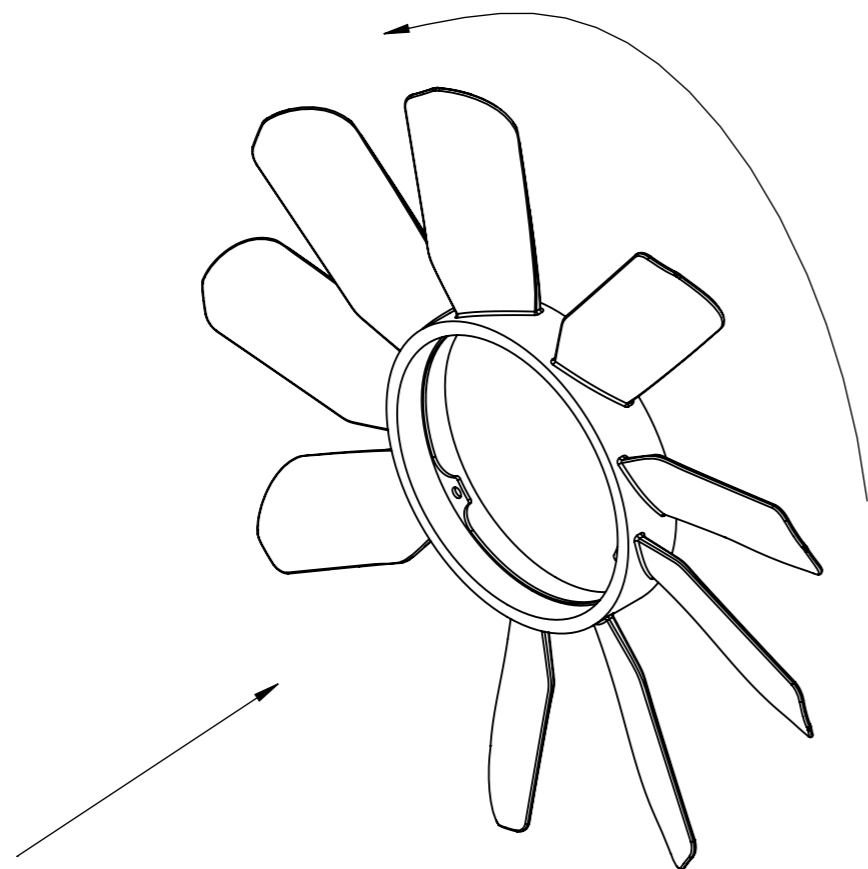

| FAN WHEEL        |                     |        |                 |
|------------------|---------------------|--------|-----------------|
| Ref.n°           | Value               | Ref.n° | Value           |
| A                | $\phi 458 \pm 3$ mm | G      | $34.6 \pm 3$ mm |
| B                | $\phi 147$ mm       | H      | $18 \pm 3$ mm   |
| C                | $\phi 135 +0.30$ mm | I      | $44 \pm 3$ mm   |
| D                | 3x $\phi 6.5$ mm    |        |                 |
| E                | 127.3 mm            |        |                 |
| F                | $\phi 180 \pm 3$ mm |        |                 |
| Number of blades |                     | 9      | Configuration   |
|                  |                     |        | CCW             |

Modification

| n° | Modified | Date | Reason |
|----|----------|------|--------|
| 4  |          |      |        |
| 3  |          |      |        |
| 2  |          |      |        |
| 1  |          |      |        |

Comments

Drawn

16/06/20 A.G.

Checked

16/06/20 R.U.

General Tolerance

ISO 2768 c-K

Material

Assembly

Part name

Technical sheet

Fan wheel

ID. Reference

8124634

Scale: 1/3

Review: 0

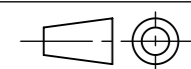

Sheet 1/1

